

2026-2027 DAY SCHOOL AND MICROSCHOOL



How to Enroll, Tuition & Fees, Calendar and Dress Code



- 📞 407-788-0018 ext. 108
- 📍 251 E. Lake Brantley Dr. Longwood, FL 32779
- 🌐 www.championprep.org

- Any Parent (New or Returning) can use this link and select REGISTER to complete a new application or a re-enrolling application.



- A current family should select I already have an account and Login (Left Option).
 - The current family will then be directed to their Family page in Version 3.0 | Select Admissions from the Menu to proceed.
- A New Family should select I need a new account (Right Option)

NEW FAMILY OPTION





NOTICE:

The link is only available for 48 hours. If they do not open the registration, the link will expire and they will have to start at the beginning.

If they begin the Registration process and do not complete it, the link will expire and they will need to start at the beginning.

Student Application Flow

NOTES

CURRENT FAMILY

NEW FAMILY

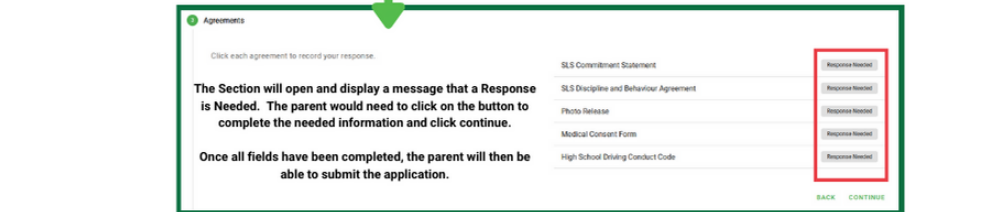
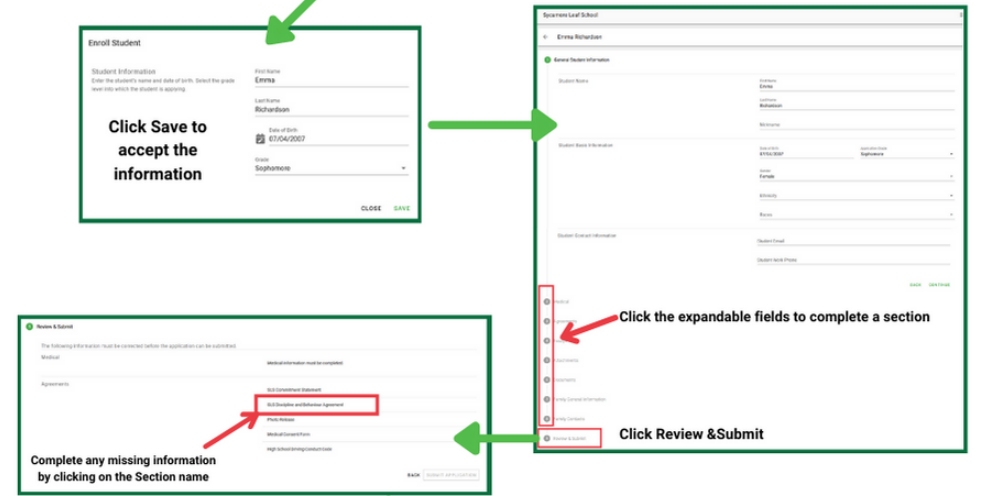
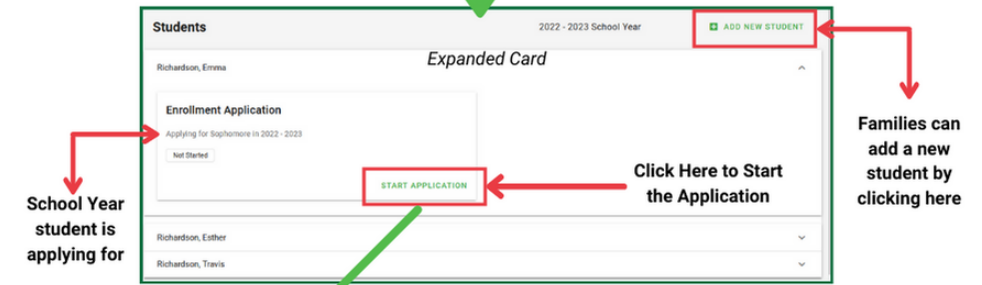
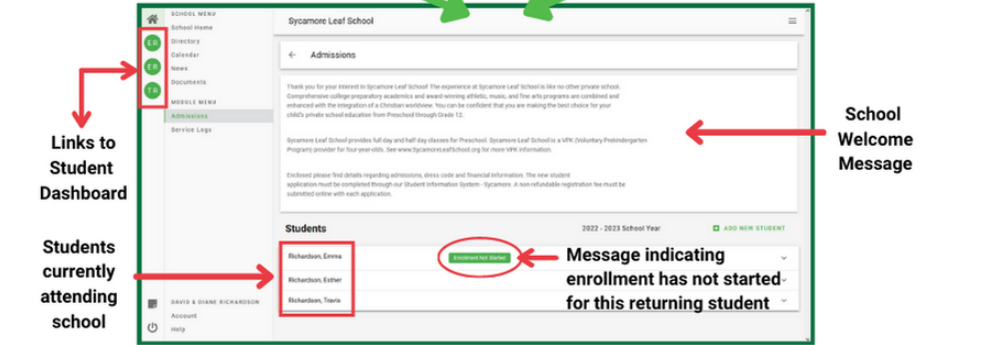

TUITION AND FEES

2026-2027

K-12 Champion Preparatory Academy (1/30/26)

Current members who complete enrollment by February 20, 2026—including registering in Sycamore, paying half of the registration fee (with the remaining balance due by April 1), and allowing the school to set up tuition payments through their FACTS account—will qualify for current member tuition rates per student.

Enrollments completed after February 20, 2026 will be subject to new member tuition rates.

Program	Non-Refundable Registration Fee Due with enrollment	Current Member Yearly Fees Feb. 9-Feb. 20, 2026	New Member Yearly Fees or Current Member after Feb., 20, 2026
One-Day Microschool—Includes Champion Academy	\$250.00	\$3,300.00	\$3,600.00
Two-Days Microschool—Includes Champion Academy	\$450.00	\$5,600.00	\$6,100.00
Two-Days—PEP Hybrid—Senior Includes CPA	\$250.00		\$5,800.00
Two-Days—PEP Hybrid—9-11 includes CPA	\$250.00		\$5,550.00
Three-Day Microschool—Includes Champion Academy	\$450.00		\$9,500.00
M - Th Day School (K-12)	\$450.00	\$10,000.00	\$10,400.00
M - F Day School (K-12)	\$450.00	\$10,500.00	\$10,800.00
M - F STAR/Transitions (Grades 7-9 & 10-12)	\$450.00	\$12,800.00	\$13,200.00
M - F Transitions (K-6)	\$450.00	\$12,200.00	\$12,600.00
Extended Morning Care (7:30-8:45 M-F)		\$1,200.00	\$1,400.00
Extended Afternoon Care (3:00-6:00 M-Th and 12:00-6:00 Fri)		\$2,100.00	\$2,900.00
Extended Care Morning & Afternoon		\$3,000.00	\$3,900.00
Drop in Extended care fee (min. fee 1 hr)	\$10.00		
Apex Online Curriculum Fee (9-12)	\$250.00		
SAT 10 Testing (3-12) Optional	\$50.00		
**Single Class Enrollment-Does not include required tuition fees for CPA Homeschool Academy			
Monday 1 hour	\$75.00	\$700.00	
Monday 1.5 hour	\$75.00	\$900.00	
T-W-Th 1.0 hr. course (Eng, History, or Science)	\$75.00	\$2500.00	
Lab Fees Not Included in Tuition (These will only be charged once we verify the classes)			
		Lab Code	
Art Club (K-5)	\$750.00	AC	
Beginning Culinary Arts (4-5)	\$200.00	CA4-5	
Choir (3-5)	\$40.00	C	
Creative Explorations (6-8)	\$75.00	CE	
Culinary Arts 1 & 2 (9-12)	\$300.00	CA	
Day on Broadway (K-5)	\$50.00	DB	
Intro. to Culinary Arts (6-8)	\$200.00	ICA	
Newspaper/Journalism	\$50.00	NJ	
Piano Keyboarding (3-8) or Guitar (6-8) - After school Class	\$700.00	PK or G	
Science Lab (Biology and Chemistry) (9-12)	\$75.00	SL	
STEAM/Robotics (6-12)	\$50.00	ST	
Technical and Performance Theater (6-12)	\$100.00	TPT	
Transitions One-time Brainware Curriculum Fee (3-8)	\$250.00	BW	

IXL Testing is included for all students.

Champion accepts the FES-EO, FES-UA, FTC, PEP and PEP Hybrid (2, 3 or 4 days per week) Vouchers

FACTS fees are paid directly to FACTS when enrolling on FACTS. \$50 for three+ payments, \$15 for two payments, and \$5 for one payment.

TUITION AND FEES CONTINUED

2026-2027 Champion Preparatory Academy

Other School Fees NOT included in tuition (add as other fees at time of registration)		Other Codes
Senior Graduation (Does not include cap and gown-parent must order)	\$250.00	SR
New 9th grade student with high school credits-High School Credit Review Fee (one time-fee)	\$50.00	9CR
New 10th grade student - High School Credit Review Fee (one-time fee)	\$175.00	10CR
New 11th grade student - High School Credit Review Fee (one-time fee)	\$275.00	11CR
New 12th grade student - High School Credit Review Fee (one-time fee)	\$375.00	12CR
Additional Fees (paid during the year as needed)		
IXL instructional program (Homeschool families)	\$50.00	
Document or Transcript Rush Fee (School has less than two weeks to complete the request)	\$40.00	
8th grade Graduation (includes cap and gown rental-student keeps commemorative tassel)	\$70.00	
VPK - K Graduation (includes cap and gown rental-student keeps commemorative tassel and diploma) No fee for VPK	\$50.00 K only	

Homeschool & Champion Academy Fee Schedule

Families registering for Day School single class enrollment, will additionally need to register for our Champion Preparatory Homeschool Academy or Champion Academy if you are receiving the Pep or FES-UA scholarship. Any 9th-12th grade students new to Champion are additionally required to pay the credit review fee.

Grade Level	Registration Fee Due with enrollment Non-refundable)	Yearly Tuition Current Member Fee April 1-April 17, 26	Yearly Tuition New Member Fee Or Current Member Fee after April 17, 2026
Grades K-8	\$75.00	\$475.00	\$575.00
Grades 9-11	\$100.00	\$625.00	\$725.00
Grade 12 with Graduation Ceremony	\$100.00	\$875.00	\$975.00
Grade 12 without Graduation Ceremony	\$100.00	\$825.00	\$925.00
Summer Extension (June-August)	\$200.00		
Homeschool Academy Late Reporting Fee (per student) (Course of Study Due-Sept., 1, Grade Reports - Due-Dec., 15/May, 15)	\$50.00		
Homeschool Academy Late Required Testing Fee (per student)	\$75.00		

2026-2027 School Calendar



August 4, 2026	Program Orientation Meeting for Day School and Transitions/STAR Full-Time Middle and High School (4- or 5-Day)
August 5, 2026	Program Orientation Meeting for Microschool 1, 2, or 3 day Orientation for Part-Time Students— All Grades
August 6, 2026	Program Orientation Meeting for Day School and Transitions Full-Time Elementary students (4- or 5-Day)
August 10, 2026	First Day of Student Attendance
September 7, 2026	No School-Labor Day
October 12–16, 2026	No School-Fall Break
November 23-27, 2026	Thanksgiving Break
December 18-Jan. 1, 2027	Christmas Break
January 4, 2027	First Day of Second Semester Classes
January 18, 2027	No School-Martin Luther King Jr. Day
February 15-19, 2027	No School-President’s Week
March 26-April 2, 2027	No School-Spring/Easter Break
May 21, 2027	Last Day of School (End of School Party)
June 4, 2027	Senior Graduation



Champion Preparatory Academy All On-Campus Programs 26-27 Dress Code Policy Rev. 5

Champion Academy's uniform policy is designed to promote consistency, modesty, and professionalism among students. The dress code ensures that all students maintain a neat, well-groomed, and appropriate appearance without drawing unnecessary attention.

Uniform Provider: All tops must be purchased through Lands' End

Website: www.landsend.com

School Code: 900199126

Dress Code by Day

- **Tuesday–Thursday:** Standard uniform requirements (boys and girls).
- **Monday & Friday:** Shirts and tops should be free of words or graphics, with school spirit T-shirts as the exception.
 - Bottoms can be any color with no rips, holes, or frayed edges. No pajama pants, athletic pants, or sweatpants
 - Shorts should be walking length (Bermuda).
 - Girls may wear Dresses, Skirts, or Skorts that should be walking length (Bermuda).
 - Hoodies, sweaters, and jackets must be a solid, single color with logo or without logo. Outerwear may not display graphics; only small brand logos are permitted.
 - All other guidelines from the Tuesday–Thursday dress code still applies.

Boys' Uniform Requirements

- Bottoms: Solid navy, khaki, black pants, joggers, or walking-length shorts (e.g., Bermuda).
 - No pajama pants, athletic pants, or sweatpants.
- Tops & Outerwear: Solid-colored polo shirts with the school's embroidered logo are required. Solid, single-colored hoodies and jackets may be worn with or without the school logo. Outerwear may not display graphics; only small brand logos are permitted.
- Footwear: Closed-toe and closed-heel shoes (athletic shoes preferred).
 - Ankle or no-show socks are preferred.

Additional Guidelines for Boys

1. Clothing must fit properly.
2. Pre-existing tattoos must be covered.
3. Hair must be well-groomed, naturally colored, and free of extreme styles (e.g., Mohawks).
 - Facial hair is not permitted.
4. Jewelry limited to one necklace and one bracelet or watch.
 - No smartwatches.
5. Clothing that is too tight, too baggy, ripped, torn, or frayed is not allowed.
6. Earrings or other piercings are not permitted.

7. Caps, hats, bandanas, and scarves are not allowed in school.

Girls' Uniform Requirements

- Bottoms: Solid navy, khaki, or black pants, capris, shorts, skirts, or skorts.
 - Shorts, skirts, and skorts must be no more than 4 inches above the knee.
 - No pajama pants, athletic pants, sweatpants, stand-alone leggings or yoga pants.
- Tops & Outerwear: Solid-colored polo shirts with the school's embroidered logo are required. Solid single-colored hoodies and jackets may be worn with or without the school logo. Outerwear may not display graphics; only small brand logos are permitted.
- Footwear: Closed-toe and closed-heel shoes (athletic shoes preferred).
 - Heels must not exceed 1 inch.
 - Ankle or no-show socks are preferred.

Additional Guidelines for Girls

1. Clothing must fit properly.
2. Pre-existing tattoos must be covered.
3. Upper-school girls may wear conservative-colored nail polish and light makeup.
4. Hair must be well-groomed, naturally colored, and free of extreme styles (e.g., Mohawks).
5. Jewelry limited to one necklace, one bracelet or watch, and one pair of small earrings. (Other piercings are not permitted).
 - No smartwatches or hoop earrings.
6. Skirts/skorts must be worn with solid navy, tan, or black biker/slider shorts underneath.
7. Leggings and biker shorts may not be worn as standalone bottoms.
8. Clothing that is too tight, too baggy, immodest (low-cut necklines, sheer fabric, off-the-shoulder, bare midriff, or short skirts), or damaged (ripped, torn, frayed) is not permitted.
9. Caps, hats, bandanas, and scarves are not allowed in school.

Cold Weather Allowance (Applies on days when temperatures are below 40°F and are not expected to rise above 55°F during the school day.)

- Students may wear a winter coat in addition to their Champion uniform shirt.
- Jeans may replace uniform pants.
- Layers may be added for warmth.
- Solid, single-colored hoodies, coats, and jackets may be worn with or without the school logo. Outerwear may not display graphics; only small brand logos are permitted.
- Solid-colored long-sleeve undershirts may be worn underneath uniform shirts.
- Boots may be worn in cold weather